

GENERAL UTILITY NOTES:

- THE CONTRACTOR IS SPECIFICALLY CAUTIONED THAT THE LOCATION AND/OR ELEVATION OF EXISTING UTILITIES AND STRUCTURES AS SHOWN ON THESE PLANS IS BASED ON RECORDS OF VARIOUS UTILITY COMPANIES AND WHERE POSSIBLE, MEASUREMENTS TAKEN IN THE FIELD. THIS INFORMATION IS NOT TO BE RELIED UPON AS BEING EXACT OR COMPLETE. THE LOCATION OF ALL UNDERGROUND UTILITIES AND STRUCTURES SHALL BE VERIFIED IN THE FIELD BY THE CONTRACTOR PRIOR TO THE START OF CONSTRUCTION. THE CONTRACTOR MUST CONTACT THE APPROPRIATE UTILITY COMPANY, ANY GOVERNING PERMITTING AUTHORITY, AND "DIGSAFE" AT LEAST 72 HOURS PRIOR TO ANY EXCAVATION WORK TO REQUEST EXACT FIELD LOCATION OF UTILITIES AND THE ENGINEER SHALL BE NOTIFIED IN WRITING OF ANY UTILITIES INTERFERING WITH THE PROPOSED CONSTRUCTION AND APPROPRIATE REMEDIAL ACTION SHALL BE TAKEN BEFORE PROCEEDING WITH THE WORK. IT SHALL BE THE RESPONSIBILITY OF THE CONTRACTOR TO RELOCATE ALL EXISTING UTILITIES WHICH CONFLICT WITH THE PROPOSED IMPROVEMENTS SHOWN ON THE PLAN.
- THE CONTRACTOR SHALL BE RESPONSIBLE FOR ESTABLISHING AND MAINTAINING ALL CONTROL POINTS AND BENCHMARKS NECESSARY FOR THE WORK.
- DURING THE COURSE OF CONSTRUCTION, THE CONTRACTOR SHALL MAINTAIN A RECORD OF ALL BURIED UTILITIES. THE "AS-BUILT" RECORDS SHALL BE PROVIDED TO THE DESIGN ENGINEER AT THE COMPLETION OF THE PROJECT.

DEMOLITION NOTES:

- ALL MATERIALS REMOVED FROM THE PREMISES SHALL BE DONE SO IN ACCORDANCE WITH APPLICABLE LOCAL, STATE AND FEDERAL REGULATIONS FOR HAULING AND DISPOSAL.
- COORDINATE ANY UTILITY DISCONNECTIONS WITH APPROPRIATE SERVICE PROVIDERS.
- ALL TREES TO REMAIN SHALL BE PROTECTED FROM CONSTRUCTION ACTIVITIES. AVOID HEAVY MACHINERY WITHIN ROOT BALL AREAS.

WATER AND SEWER NOTES:

- THE ONSITE SEWAGE DISPOSAL SYSTEM DESIGN SHALL BE APPROVED BY THE TOPSFIELD BOARD OF HEALTH.
- A MINIMUM OF 10 FEET CLEAR HORIZONTAL SEPARATION SHALL BE MAINTAINED BETWEEN SANITARY SEWER PIPES AND WATER PIPES UNLESS CONDITIONS PREVENT A LATERAL SEPARATION OF LESS THAN 10 FEET. WHERE SANITARY SEWERS CROSS WATER SERVICES OR A MINIMUM OF 10 FEET LATERAL SEPARATION CANNOT BE ACHIEVED THE WATER PIPE SHALL BE SLEEVED IN PVC FOR A MINIMUM DISTANCE OF 10 FEET FROM THE CROSSING POINT OF THE SEWER PIPE AND SEALED AT EACH END.
- ALL GRAVITY SEWER PIPE SHALL BE POLYVINYL CHLORIDE (PVC) SCH40 UNLESS OTHERWISE NOTED.
- WATER SERVICE CONNECTIONS SHALL HAVE A MINIMUM 5' OF COVER TO PREVENT FREEZING. THE TOPSFIELD WATER DEPARTMENT SHALL BE NOTIFIED PRIOR TO WATER SERVICE INSTALLATION.

STORM DRAIN NOTES:

- BACKFILL SHALL BE COMPACTED TO 95% MAXIMUM DRY DENSITY BY AASHTO T-180D METHOD.
- SHEETING, IF USED, SHALL BE REMOVED PRIOR TO BACKFILLING TRENCH.
- UNSATURABLE SOIL BELOW THE INVERT SHALL BE REMOVED AND REPLACED WITH APPROVED MATERIAL AND SHALL NOT BE USED AS BACKFILL.
- UNSATURABLE MATERIALS SHALL BE REMOVED FROM BENEATH THE INFILTRATION BASIN AND CHAMBER SYSTEM AND REPLACED WITH CLEAN, GRANULAR FILL MEETING THE ASTM C33 SPECIFICATIONS (CONCRETE SAND).

Planting Notes:

- Disturbed soils will be planted with our custom wetland and upland seed mixes.
- The entire planted area is to be covered with salt marsh hay to retain soil moisture and protect against seed predation by birds and small mammals.
- Plants to be distributed by an ecological restoration specialist. Exact plant locations will be determined in the field based on site-specific planting conditions and micro-topography.
- The new plantings will be irrigated for one full growing season or until the seed and plant material is established.
- Monthly inspections will be conducted for the first growing season and treatment/removal of invasive species will be implemented as needed.
- Care is to be taken in removing invasive plant material to minimize disturbance to existing native plant species.

Proposed Plant List | 371 Boston Street Topsfield MA

ID	COMMON NAME	BOTANICAL NAME	INDICATOR	SIZE	QUANTITY
1	Sugar Maple	<i>Acer saccharum</i>	FACU	2-inch caliper	3
2	Red Fescue	<i>Festuca rubra</i>	FACU	Seed	10 lbs
3	Highbush Blueberry	<i>Vaccinium corymbosum</i>	FACW	3 gallon	12
4	Shadbush	<i>Amelanchier canadensis</i>	FAC	3 gallon	12
5	Sheep Laurel	<i>Kalmia angustifolia</i>	FAC	1 gallon	12
6	New England Aster	<i>Symphyotrichum novae-angliae</i>	FACW	1 gallon	12
7	Pink Tickseed	<i>Coreopsis rosea</i>	FACU	1 gallon	12
8	Little Bluestem	<i>Schizachyrium scoparium</i>	FACU	1 gallon	12
9	Switchgrass	<i>Panicum virgatum</i>	FAC	1 gallon	12
10	Rough Goldenrod	<i>Solidago rugosa</i>	FACU	1 gallon	12

Proposed Basin Plant List | 371 Boston Street Topsfield MA

ID	COMMON NAME	BOTANICAL NAME	INDICATOR	SIZE	QUANTITY
A	Soft Rush	<i>Juncus effusus</i>	OBL	Seed	Total seed
B	Sensitive Fern	<i>Onoclea sensibilis</i>	FACW	Seed	mix to be 25
C	Riverbank Wildrye	<i>Elymus riparius</i>	FACW	Seed	pounds
D	Rough Bentgrass	<i>Agrostis scabra</i>	FAC	Seed	
E	Fowl Bluegrass	<i>Poa palustris</i>	FACW	Seed	
F	Virginia Wildrye	<i>Elymus virginicus</i>	FACW-	Seed	

Buffer Zone Enhancement Plan

371 Boston Street | Topsfield, MA

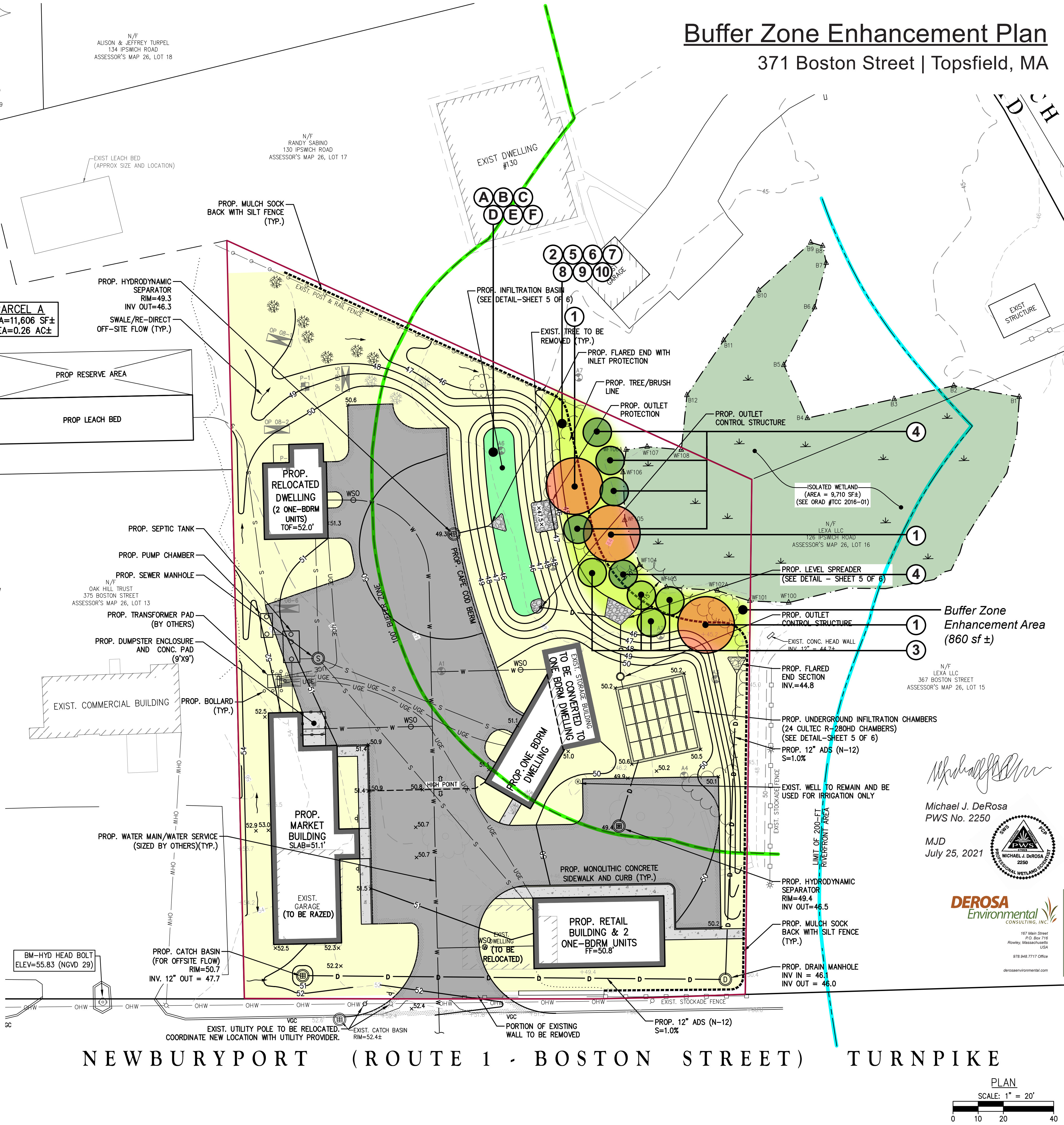

The Morin-Cameron GROUP, INC.
CIVIL ENGINEERS / ENVIRONMENTAL CONSULTANTS
LAND SURVEYORS / LAND USE PLANNERS
66 ELM STREET, DANVERS, MASSACHUSETTS 01923
P: 978-777-8886, F: 978-774-5468, W: WWW.MORIN-CAMERON.COM

SURVEY BY:	PM/SR
DRAFTED BY:	WAS
CHECKED BY:	JMM
APPROVED BY:	JMM
SCALE:	AS NOTED
DATE:	OCTOBER 23, 2019

NO.	DESCRIPTION	DATE
1	MODIFY PARKING	6/15/2021

SITE PLAN OF LAND IN TOPSFIELD, MASSACHUSETTS
371 BOSTON STREET
(ASSESSOR'S MAP 26, LOT 14)
PREPARED FOR:
MAUREEN & RANDY SABINO

GRADING, UTILITY & DRAINAGE
DRAWING NO.
4 OF 6